

UL 1 hr. fire rated wall assembly (as needed) extended to roof sheathing $\frac{3}{8}$ " type gwb, 2x6 studs @ 16" o.c. Mineral wool insulation. 1 sided LP Flame Block wall sheathing (or equal) Hardie Plank exterior siding

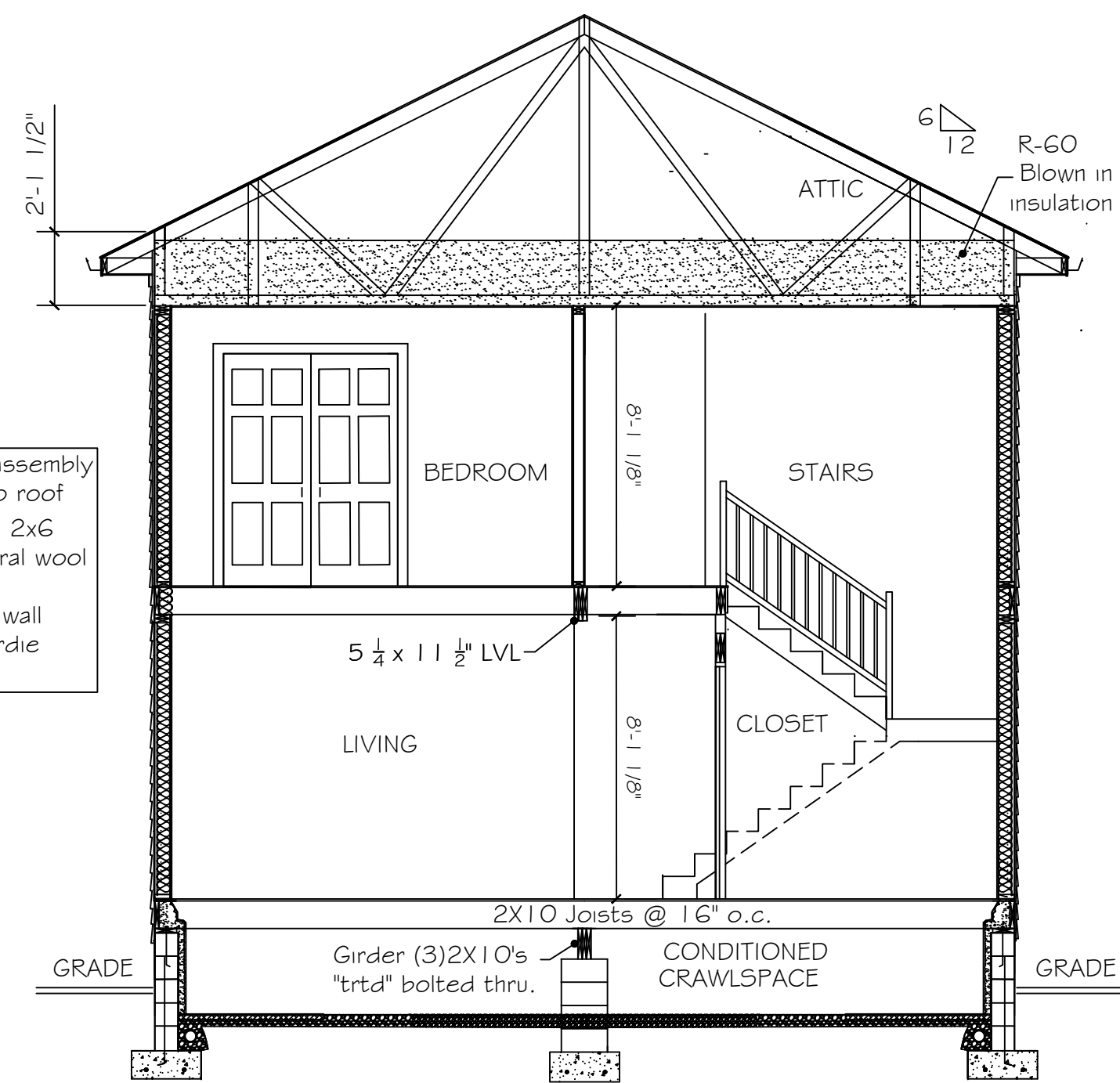

Section A-A
SCALE: 1/4" = 1'-0"

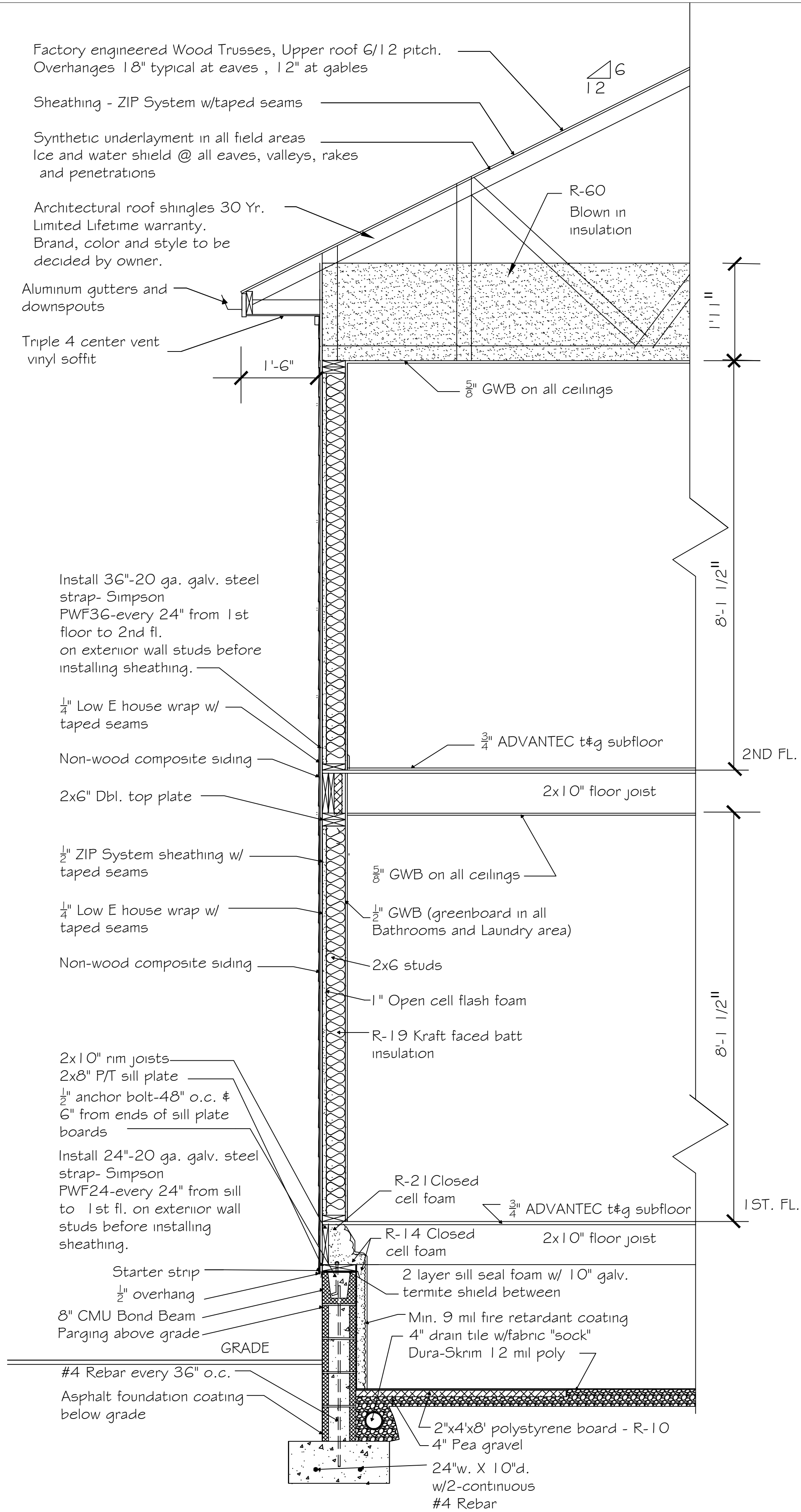

TYPICAL WALL SECTION
SCALE: N.T.S.

<p>TRANQUIL WATERS DESIGN</p> <p>P.O. BOX 547 ST. MICHAELS MD. 21663 804-761-0483 PHONE tranquilwatersdesign@gmail.com</p>	<p>REMODELING OF 500 PINE STREET CAMBRIDGE DORCESTER CO., MD.</p>		<p>JOB: 500 PINE ST.</p>
	<p>DATE ISSUED NOV.11, 2024</p> <p>REVISIONS</p>	<p>A4</p> <p>SECTIONS</p>	